

PRELIMINARY ISSUE
THIS PLAN ISSUED FOR
ADVANCE INFORMATION ONLY

US Army Corps of Engineers
San Francisco District
450 Market Street
San Francisco, CA 94102

DISCLAIMER
The United States Government furnishes this information as a service to the public. It is not intended to be used for any purpose other than the intended purpose. The user is responsible for the results of any application of the data for other than the intended purpose. The United States Government makes no warranty, expressed or implied, concerning the accuracy, completeness, or timeliness of the information furnished. The United States Government assumes no liability whatsoever to any person by reason of any use made thereof. These data belong to the Government. Therefore the recipient may not transfer these data to others without also transferring this disclaimer.

NAD 1983 CENTERLINE ANGLE POINTS			
ANGLE	PT	X	Y
	C01	5986334.07	2182035.55
	C02	5997909.67	2176773.45

NAD 1983 CHANNEL ANGLE POINTS			
ANGLE	PT	X	Y
1		5986637.57	2181930.55
2		5987101.87	2181719.45
3		5987110.07	2181737.65
4		5997928.37	2176818.95
5		5997886.97	2176727.95
6		5987076.67	2181646.65
7		5987076.97	2181664.85
8		5986606.07	2181878.95

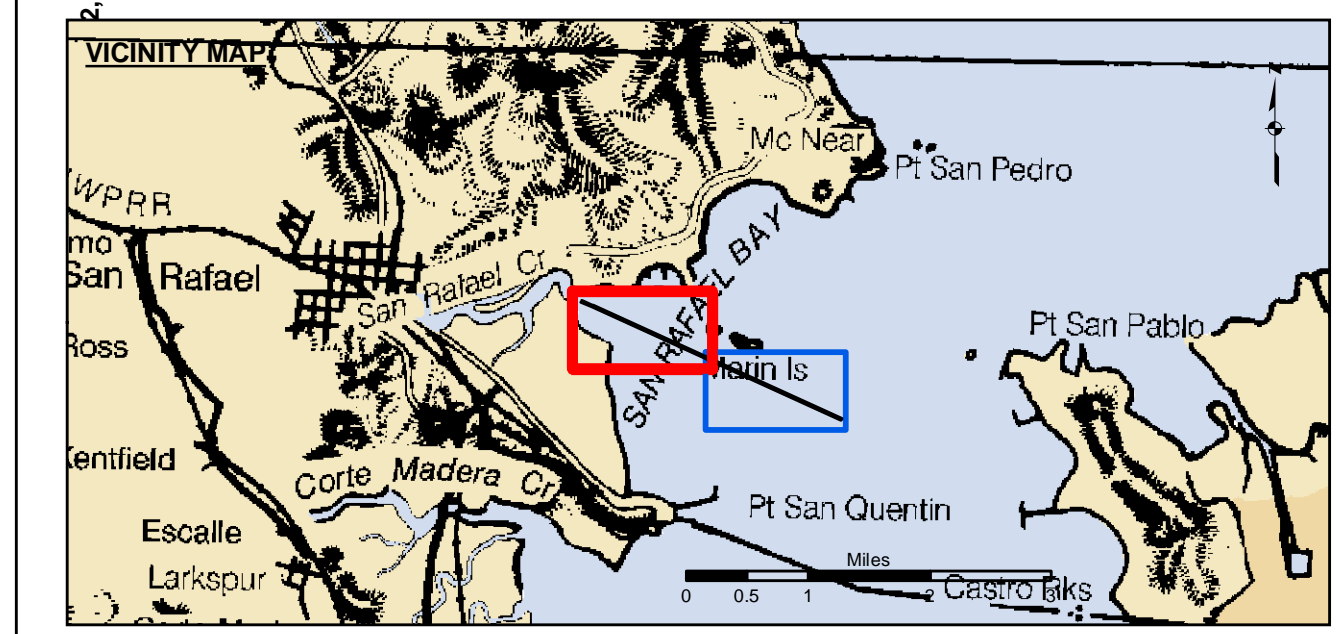
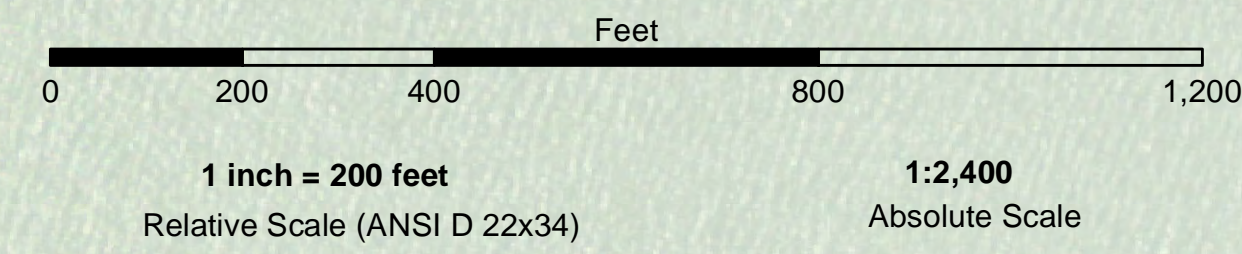

Federal Navigation Channel	Beacon, General	Contours
Shoaling Area	Obstruction Point	
Placement Area	Navigation Buoy	-8
Anchorage Area	Navigation Buoy	-7
Wreck Area	Shoalest Sounding*	-6
Submerged Wreck		-5
Angle Point		-4

NOTES:
DRAWING NOT TO BE USED FOR NAVIGATION. ONLY CHANNEL CONDITION AT DATE OF SURVEY. THE LOCATION OF ALL NAVIGATION AIDS ARE BASED ON INFORMATION PROVIDED BY THE U.S. COAST GUARD. BUOY LOCATIONS REPRESENT THE POSITION OF THE SINKER ONLY.
SURVEYED BY THE CORPS OF ENGINEERS.
SOUNDINGS FOR THE OUTSIDE CHANNEL (100 FT WIDE) TAKEN BY FATHOMETER; THE INSIDE CHANNEL (60 FT WIDE) TAKEN BY LEAFLINE, AND ARE SHOWN TO THE NEAREST FOOT AND TENTH OF A FOOT.
SOUNDINGS ARE BASED ON THE DATUM OF MEAN LOWER LOW WATER AT THE LOCALITY.

PLANE GRID AND COORDINATES ARE BASED ON LAMBERT PROJECTION, ZONE III NAD 83, CALIFORNIA, AS DESCRIBED IN SPECIAL PUBLICATION NO. 235, PUBLISHED BY NATIONAL OCEAN SURVEY.
THE PROJECT DEPTH IS 8 FEET IN 100 FT WIDE CHANNEL ACROSS THE FLATS, THENCE 6 FT IN 60 FT WIDE CHANNEL IRWIN STREET
SOUNDINGS ARE BASE ON TIDE GAGE LOCATED AT EASTERLY END OF TURNING BASIN, AND REFERENCED TO U.S.C. & G.S. TIDAL B.M. NO. 17, A STD. DISK SET IN N.W. CORNER OF PUMP HOUSE DECK AT S. END OF YACHT CLUB BASIN, ON N. SIDE OF U.S. HWY. 101, AND 0.5 MI. S.E. OF SAN RAFAEL ELEVATION 9.81 FT ABOVE M.L.L.W.
SOUNDINGS ABOVE DATUM ARE PREFIXED WITH A (+) SIGN.

Prepared Under the Direction of JOHN D. CUNNINGHAM LT. COLONEL, C.E., DISTRICT ENGINEER	Chart Date: Jun 03, 2020
Subject: Hydro Survey Team Leader	Designed by: PDT
Recommended by: Chief, Hydro Survey Section	Drawn by: PDT
Approved by: Chief, Construction Branch	Checked by: PDT

CALIFORNIA
MARIN COUNTY
SAN RAFAEL CREEK
CONDITION SURVEY
28 MAY 2020

Sheet Reference Number
1 of 2

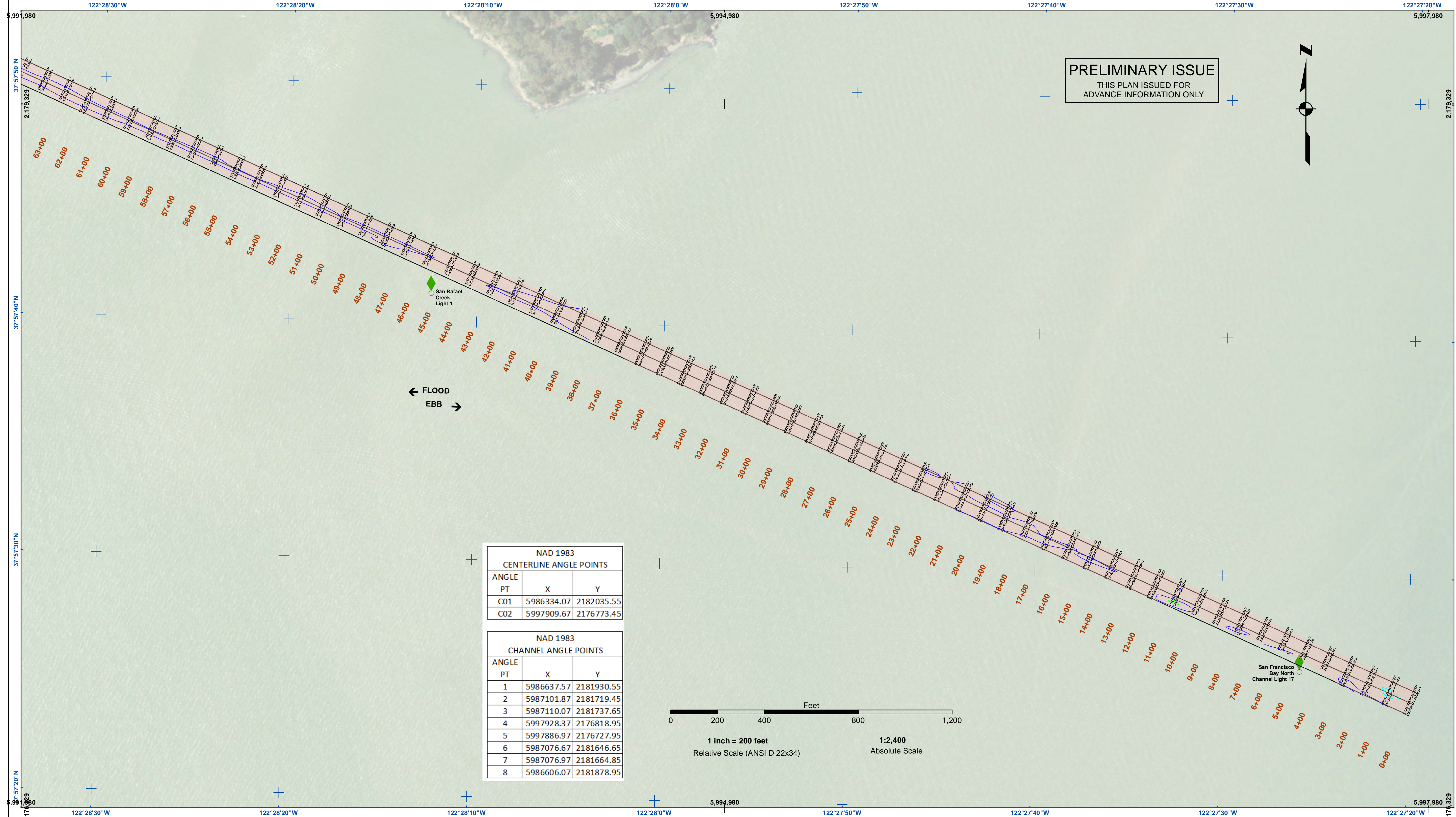

PRELIMINARY ISSUE
THIS PLAN ISSUED FOR
ADVANCE INFORMATION ONLY

US Army Corps of Engineers
San Francisco District
450 Market Street
San Francisco, CA 94102

DISCLAIMER
The United States Government furnishes this information for the purpose of providing accurate and reliable data for the use of the user. The user is responsible for the results of any application of the data for other than its intended purpose. The user is responsible for the results of any application of the data for other than its intended purpose. The user is responsible for the results of any application of the data for other than its intended purpose.

← FLOOD
EBB →

NAD 1983 CENTERLINE ANGLE POINTS		
ANGLE PT	X	Y
C01	5986334.07	2182035.55
C02	5997909.67	2176773.45

NAD 1983 CHANNEL ANGLE POINTS		
ANGLE PT	X	Y
1	5986637.57	2181930.55
2	5987101.87	2181719.45
3	5987110.07	2181737.65
4	5997928.37	2176818.95
5	5997886.97	2176727.95
6	5987076.67	2181646.65
7	5987076.97	2181664.85
8	5986606.07	2181878.95

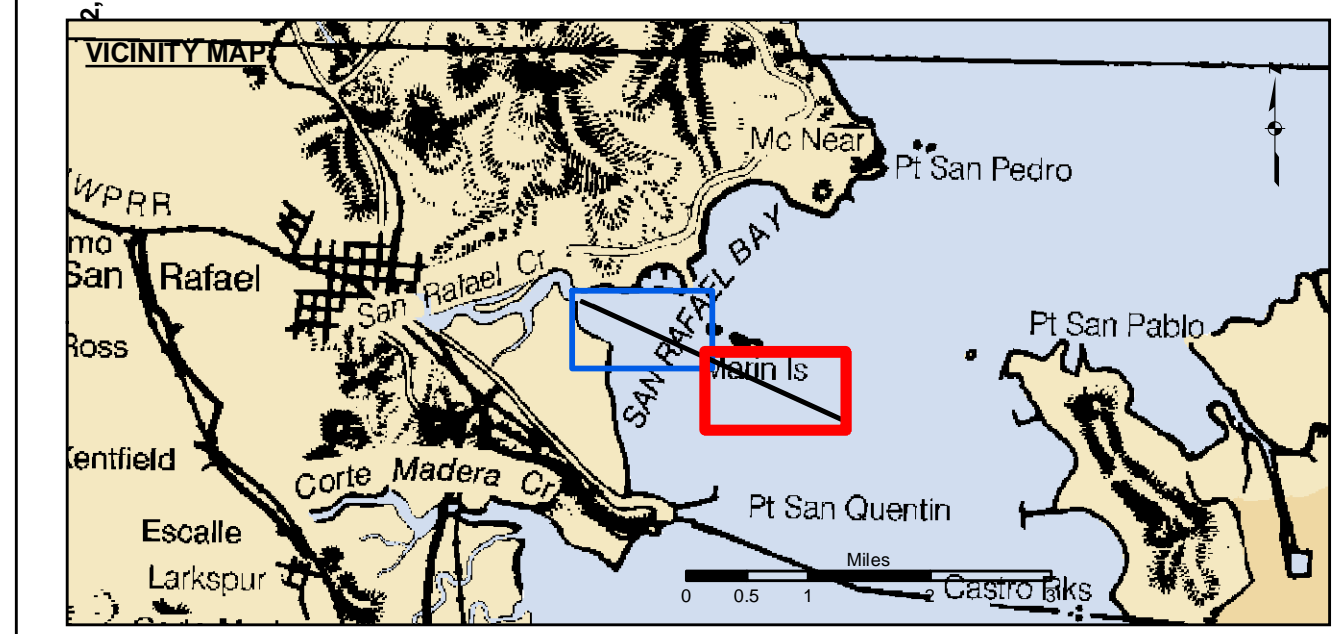
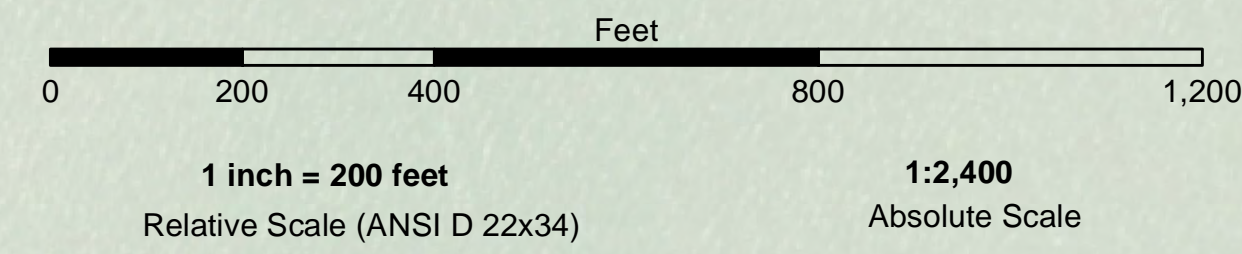

- Federal Navigation Channel
- Shoaling Area
- Placement Area
- Anchorage Area
- Wreck Area
- Submerged Wreck
- Angle Point
- Beacon, General
- Obstruction Point
- Navigation Buoy
- Navigation Buoy
- Shoalest Sounding*
- Contours**
- 8
- 7
- 6
- 5
- 4

NOTES:
DRAWING NOT TO BE USED FOR NAVIGATION. ONLY CHANNEL CONDITION AT DATE OF SURVEY. THE LOCATION OF ALL NAVIGATION AIDS ARE BASED ON INFORMATION PROVIDED BY THE U.S. COAST GUARD. BUOY LOCATIONS REPRESENT THE POSITION OF THE SINKER ONLY.
SURVEYED BY THE CORPS OF ENGINEERS.
SOUNDINGS FOR THE OUTSIDE CHANNEL (100 FT WIDE) TAKEN BY FATHOMETER; THE INSIDE CHANNEL (60 FT WIDE) TAKEN BY LEAFLINE, AND ARE SHOWN TO THE NEAREST FOOT AND TENTH OF A FOOT.
SOUNDINGS ARE BASED ON THE DATUM OF MEAN LOWER LOW WATER AT THE LOCALITY.

PLANE GRID AND COORDINATES ARE BASED ON LAMBERT PROJECTION, ZONE III NAD 83, CALIFORNIA, AS DESCRIBED IN SPECIAL PUBLICATION NO. 235, PUBLISHED BY NATIONAL OCEAN SURVEY.
THE PROJECT DEPTH IS 8 FEET IN 100 FT WIDE CHANNEL ACROSS THE FLATS, THENCE 6 FT IN 60 FT WIDE CHANNEL IRWIN STREET
SOUNDINGS ARE BASE ON TIDE GAGE LOCATED AT EASTERLY END OF TURNING BASIN, AND REFERENCED TO U.S.C. & G.S. TIDAL B.M. NO. 17, A STD. DISK SET IN N.W. CORNER OF PUMP HOUSE DECK AT S. END OF YACHT CLUB BASIN, ON N. SIDE OF U.S. HWY. 101, AND 0.5 MI. S.E. OF SAN RAFAEL ELEVATION 9.81 FT ABOVE M.L.L.W.
SOUNDINGS ABOVE DATUM ARE PREFIXED WITH A (+) SIGN.

Prepared Under the Direction of JOHN D. CUNNINGHAM LT COLONEL, C.E., DISTRICT ENGINEER	Chart Date: Jun 03, 2020
Submitted: PDT	Designed by:
Recommended: Chief, Hydro Survey Section	Plotted by:
Approved: Chief, Construction Branch	Checked by: PDT
	Drawn by: PDT

CALIFORNIA
MARIN COUNTY
SAN RAFAEL CREEK
CONDITION SURVEY
28 MAY 2020

Sheet Reference Number
2 of 2